

# FIVE STAR

P R O P E R T Y



## 23 Woodlands, Retford, Nottinghamshire, DN22 7AB

GROUND FLOOR APARTMENT - 2 BEDROOMS - LOUNGE - KITCHEN - BATHROOM - GAS CENTRAL HEATING & DOUBLE GLAZING - PRIVATE GARDEN - POPULAR RESIDENTIAL AREA - IDEAL INVESTMENT PROPERTY - CALL FIVE STAR PROPERTY FOR MORE DETAILS.

- 2 Bed, Ground Floor Apartment
- Well Appointed Throughout
- Private Garden & Outside Store
- Gas Central Heating & D/G
- Popular Residential Area
- EPC Rating: C

**£100,000**

# GROUND FLOOR

APPROX. 50.4 SQ. METRES

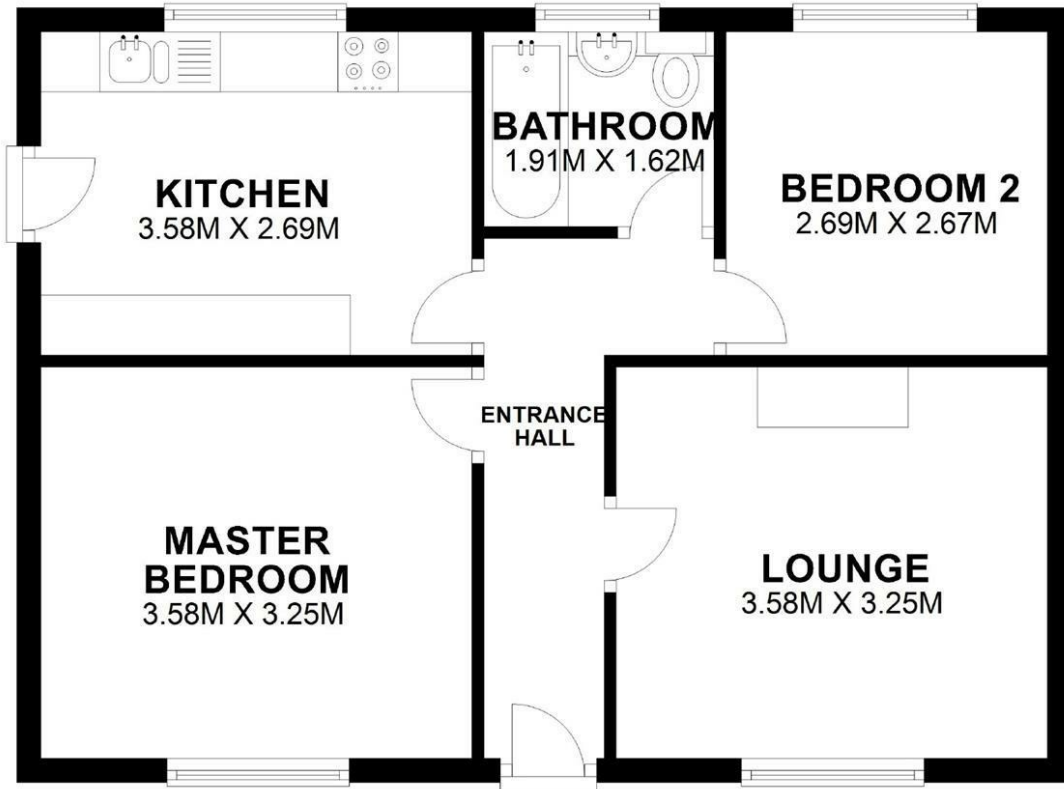

TOTAL AREA: APPROX. 50.4 SQ. METRES

Energy Efficiency Rating		Current	Potential
Very energy efficient - lower running costs			
(92 plus) A			
(81-91) B			
(69-80) C			
(55-68) D			
(39-54) E			
(21-38) F			
(1-20) G			
Not energy efficient - higher running costs			
England & Wales		73	76
		EU Directive 2002/91/EC	

Environmental Impact (CO <sub>2</sub> ) Rating		Current	Potential
Very environmentally friendly - lower CO <sub>2</sub> emissions			
(92 plus) A			
(81-91) B			
(69-80) C			
(55-68) D			
(39-54) E			
(21-38) F			
(1-20) G			
Not environmentally friendly - higher CO <sub>2</sub> emissions			
England & Wales		1	1
		EU Directive 2002/91/EC	